

# TYPE S STARCO™

The original STARCO™ Super Low Profile Elevator Bucket System - a bucket design for higher capacity at closer bucket spacing.

- > **Higher capacity:** up to 100% capacity increase for existing elevators
- > **More flexibility:** operates effectively over a wide speed range (from 1.25 m/s to 4.55 m/s)
- > **Unique stream discharge pattern:** reduces product damage and dust

PRESSED SEAMLESS STEEL / STAINLESS STEEL / GALVANISED

Agricultural

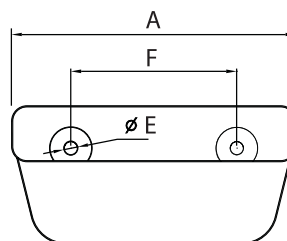
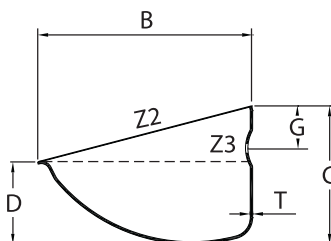

No.	A (mm)	B (mm)	C (mm)	D (mm)	T (mm)	(kg)	Capacity (Litres)		Holes			Max. Pcs/Mtr	
							Z2 (total)	Z3 (water)	No.	E (Ø mm)	F (mm)		G (mm)
S100-90*	Only available for spares; now offering the SPS100-90 (see page 4)												
S130-120	138	114	80	54	1.5	0.35	0.68	0.50	2	8.5	70	22	12
S180-140	188	140	92	60	1.5	0.53	1.29	0.90	2	8.5	100	27	10.5
S230-140	237	142	92	59	1.5	0.76	1.73	1.22	2	9.0	120	28	10.5
S230-165	239	163	108	70	2.0	1.01	2.47	1.84	2	11.0	120	34	9
S280-165	289	163	108	70	2.0	1.32	3.05	2.30	3	11.0	80	34	9
S300-180	308	182	117	70	2.0	1.43	3.66	2.46	3	9.0	100**	35	8.13
S300-215	310	217	140	89	2.0	2.05	5.60	4.10	3	11.0	100	38	7.14
S330-215/2.0	340	213	134	85	2.0	2.09	5.51	3.92	3	11.0	120	38	7.14
S330-215/2.5	340	213	134	85	2.5	2.68	5.51	3.92	3	11.0	120	38	7.14
S370-215/2.0	381	213	134	85	2.0	2.38	6.18	4.40	4	11.0	90	38	7.14
S370-215/2.5	381	213	134	85	2.5	2.98	6.18	4.40	4	11.0	90	38	7.14
S450-215	464	213	134	85	2.5	3.40	8.00	5.59	5	11.0	90***	38	7.14

Special holes/thicknesses/wearbands - available on request

\* The original S100-90 is still available for spares / \*\* S300-180 Slotted holes for 100mm centres to 104mm centres

\*\*\* S450-215 Slotted holes for 88mm centres to 90mm centres. Wear band 3.0mm on 1 or 3 sides on request

! FOR STAINLESS STEEL, SEE PRICE LIST FOR THICKNESS OPTIONS

Free Engineering Design Service - contact 4B or visit: [www.go4b.com](http://www.go4b.com)