

# TYPE S STARCO™

DID YOU KNOW... The Starco bucket was originally invented by 4B Braine's French subsidiary, SETEM, in the 1980s and was the first low profile elevator bucket to use centrifugal discharge on a parabolic elevator head to achieve much higher capacities on a given elevator leg. As such, the STARCO bucket has revolutionised the elevator buckets market.



HDP / NYLON / POLYURETHANE

Agricultural

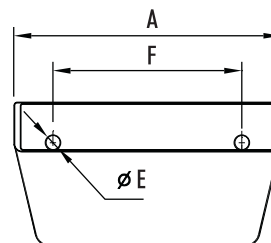
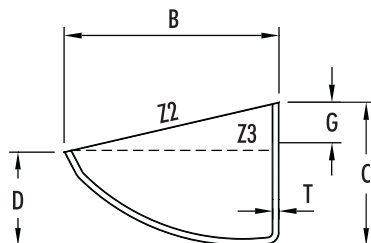

No.	A (mm)	B (mm)	C (mm)	D (mm)	T (mm)	(kg)	Capacity (Litres)		Recessed Holes			Available Options	Max. Pcs/Mtr	
							Z2 (total)	Z3 (water)	No.	E (Ø mm)	F (mm)			G (mm)
S100-90 HDP-MD	109	90	62	39	4	0.06	0.30	0.23	2	8.5	50	17	R	14.28
S130-120 HDP-MD	140	121	81	54	4.7	0.13	0.65	0.50	2	8.5	70	22	R	11.11
S150-110 HDP	159	113	78	51	5.2	0.17	0.66	0.49	2	9.0	89	24	N-F	12
S180-140 HDP-MD	190	148	94	55	5.5	0.21	1.34	0.95	2	8.5	100	30	R	10.5
S180-140 HDP	190	146	94	56	6	0.22	1.25	0.98	2	9.0	100	30	N-F	10.5
S225-140 HDP	235	140	94	60	6	0.34	1.68	1.29	2	9.0	120	30	N	10.5
S230-170 HDP-MD	240	175	111	70	5.5	0.36	2.52	2.00	2	11.0	120	38	R	9
S230-170 HDP	240	173	110	70	6	0.43	2.43	1.79	2	11.0	120	35	N	9
S280-170 HDP-MD	290	173	111	75	6	0.45	3.08	2.48	3	11.0	80	38	R	9
S280-170 HDP	290	173	113	72	6	0.5	3.00	2.3	3	11.0	80	35	N-F	9
S300-180 HDP	314	181	124	81	6	0.58	3.90	2.75	3	9.0	102	38	N-F	8.13
S350-180 HDP	367	181	124	85	7	0.79	4.51	3.30	4	9.0	90	38	N-F	8.13
S330-215 HDP	342	222	141	92	8.5	0.93	5.97	4.43	3	11.0	120	38	R	7.14
S370-215 HDP	382	218	142	92	9	1.07	5.84	4.24	4	11.0	90	38	N-F-R	7.14

N = no holes / F = flat holes / R = recessed holes