

POLYPENCO NBA & DIN 15234

Polypenco 'Nylatron' cast nylon buckets are designed for tough longlife solutions for industrial applications. Polypenco buckets can be used in new installations or in retro-fit situations and are available in 2 styles/ranges: NBA - for use in relatively narrow elevator legs DIN - for elevators designed around DIN NORM 15234.

- > Heavy-duty construction with thick bucket walls
- > Impact, corrosion and abrasion resistant for a long working life
- > Suitable for both chain and bucket or belt and bucket applications
- > Non-stick quality reducing product build-up and reserving maximum elevator capacity
- > Temperature resistant: handles products up to max. 110°C

NBA & DIN 15234 IMPACT-WEAR-CORROSION RESISTANT CAST NYLATRON

Industrial/Sticky

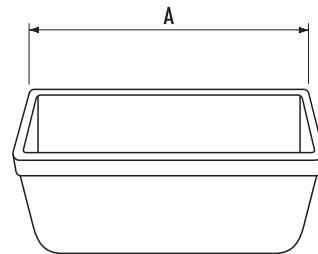
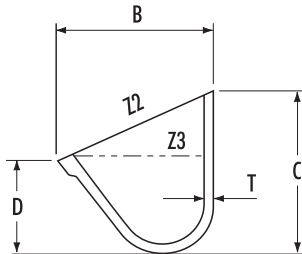

No.	A (mm)	B (mm)	C (mm)	D (mm)	T (mm)	(kg)	Capacity (Litres)	
							Z2 (total)	Z3 (water)
NBA 8	206	111	127	73	8	0.59	1.20	0.98
NBA 10	254	123	141	82	8	0.79	1.85	1.44
NBA 12	318	167	164	93	8	1.13	4.50	2.70
NBA 14	362	179	190	109	8	1.53	6.10	4.00
NBA 15	370	206	223	131	8	1.80	8.57	5.76
NBA 16	413	210	203	113	8	1.81	9.30	5.60
NBA 18	457	198	229	143	8	2.50	11.10	7.50
DIN 200/160	224	178	209	109	8	1.25	3.65	2.23
DIN 250/180	274	199	233	121	8	1.59	5.60	3.54
DIN 315/200	339	219	260	135	8	2.38	9.90	5.39
DIN 400/225	426	244	291	153	8	3.18	15.20	9.05
DIN 500/250	526	269	328	176	8	4.20	23.92	14.38
DIN 630/280	656	301	364	193	8	5.44	37.20	22.70

Bolt holes drilled to customer specification

Free Engineering Design Service - contact 4B or visit: www.go4b.com

