

Industrial Duty Toughened Nylon Buckets. "Continuous" Style Heavy Duty Injection Moulded Nylon.

- > **Solid construction:** manufactured from DuPont 'Zytel' ST super-tough nylon urethane or high density polyethylene
- > **Solid through and through:** no occlusions within the structure
- > **Medium front** for use in continuous discharge elevators
- > **Corrosion and abrasion resistant**
- > For use in applications up to 150°C

NYLON 'ZYTEL'

Industrial

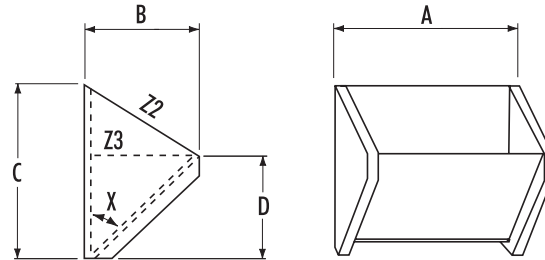
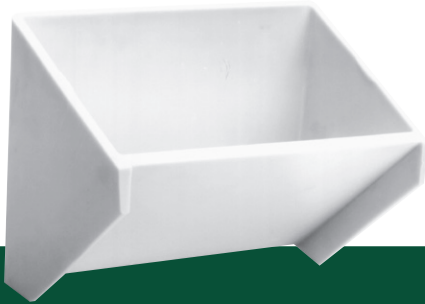

No.	Nominal Size (mm)	A (mm)	B (mm)	C (mm)	D (mm)	T (mm)	X°	Capacity (Litres)		
								(kg)	Z2 (total)	Z3 (water)
MF85	200 x 130	210	140	190	118	8	50	0.88	2.04	1.22
MF105	250 x 130	260	140	190	118	8	50	1.07	2.50	1.55
MF128	300 x 200	310	216	300	175	8	50	2.17	8.01	4.77
MF148	350 x 200	362	216	300	175	8	50	2.36	9.01	5.51
MF168	400 x 200	413	216	300	175	8	50	2.61	10.55	6.42
MF188	450 x 200	463	216	300	175	8	50	2.85	12.10	7.24

Mounting holes and venting to customer specification

