

# TYPE GB/GB 型 GB / Spidex™ Bottomless/GB / Spidex™ (无底型)



www.go4b.com



FREE Engineering Design Service  
www.go4b.com

免费工程设计服务 www.go4b.com

Bottomless elevator bucket system. GB Spidex™ buckets are closely spaced with a series of buckets without bottoms followed by one bucket with a bottom. The material is lifted in a continuous column and the carrying space normally wasted between conventional buckets is fully utilized to achieve much greater capacity. The buckets pick up and discharge conventionally, but care must be taken in the design of the boot and the head.

无底型提升机料斗系统。GB Spidex™ 料斗以一系列无底料斗后面跟随一个有底料斗的方式密集相间排列。按照一个连续的列提升材料，并将传统料斗之间通常被浪费的运载间距充分利用起来，以获得更大的容量。料斗按照传统方式抓举和卸料，但在设计给料室和机头时必须小心。

- Optimum possible capacity for a given elevator case
- Cost effective increase in leg capacity
- Self-cleaning, vented system - ideal for sticky and powdery products

- 针对指定的提升机案例提供尽可能最佳的容量
- 以具有成本效益的方式提升支架容量
- 自动清洁通风系统 - 粘性产品和粉状产品的理想选择

Pressed Seamless Steel /  
Stainless Steel

压制无缝钢/  
不锈钢



AGRICULTURAL/农业

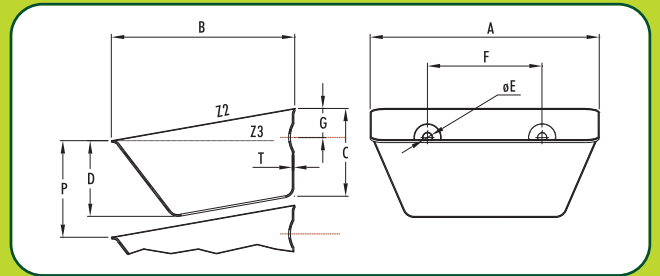

Code No. 代码编号	A (mm)	B (mm)	C (mm)	T (mm)	kg	Capacity (Litres) 容量 (升) Z2 (total) (总计)	Z3 No. 编号	Recessed Holes 切槽孔			P** (mm)	Pcs/Mtr
								E (Ø mm)	F (mm)	G (mm)		
<b>STANDARD RANGE / 标准范围</b>												
GB130-110-B	136	114	51	1.5	0.30	0.50	2	8.5	70	22	57	17.5
GB130-110+B	136	114	51	1.5	0.36	0.50	2	8.5	70	22	57	17.5
GB180-140-B	185	139	65	1.5	0.45	1.18	2	9.0	100	32	71	14.0
GB180-140+B	185	139	65	1.5	0.55	1.18	2	9.0	100	32	71	14.0
GB230-165-B	237	163	71	2.0	0.83	2.10	2	10.0	120	32	80	12.5
GB230-165+B	237	163	71	2.0	1.12	2.10	2	10.0	120	32	80	12.5
GB300-165-B	305	166	80	2.0	1.10	2.75	3	10.5	90*	36	88	11.4
GB300-165+B	305	166	80	2.0	1.40	2.75	3	10.5	90*	36	88	11.4
GB350-200-B	355	200	100	2.5	1.95	4.75	4	11.0	90	42	111	9.0
GB350-200+B	355	200	100	2.5	2.50	4.75	4	11.0	90	42	111	9.0
GB400-220-B	410	218	115	3.0	2.30	6.91	4	11.0	100	45	125	8.0
GB400-220+B	410	218	115	3.0	2.95	6.91	4	11.0	100	45	125	8.0

\*\* Bucket spacing for free flowing granular products only.

\* Fixing Holes GB300-165. Alternative hole punching available: Slotted for 101mm to 104mm centres

\*\* 料斗间距仅适用于自由流动的粒状产品。

\* 安装孔 GB300-165。可提供替代冲孔：长槽孔（针对 101mm 至 104mm 中心）。

<b>SPECIAL RANGE / 特殊范围</b>												
GB215-95-B	220	93	63	1.5	0.40	0.95	2	8.5	127	25	67	14.9
GB215-95+B	220	93	63	1.5	0.50	0.95	2	8.5	127	25	67	14.9
GB380-165-B	380	165	80	2.5	1.70	3.50	4	9.0	*	36	88	11.4
GB380-165+B	380	165	80	2.5	2.15	3.50	4	9.0	*	36	88	11.4
GB325-190-B	335	191	88	2.5	1.65	3.60	3	9.0	100	25	100	10.5
GB325-190+B	335	191	88	2.5	2.11	3.60	3	9.0	100	25	100	10.5
GB400-200-B	410	200	97	2.0	1.66	5.40	4	9.0	94	32	105	9.5
GB400-200+B	410	200	97	2.0	2.20	5.40	4	9.0	94	32	105	9.5
GB430-200-B	437	200	95	2.0	1.77	5.56	4	9.0	94	32	105	9.5
GB430-200+B	437	200	95	2.0	2.30	5.56	4	9.0	94	32	105	9.5

\*\* Bucket spacing for free flowing granular products only.

\* Fixing Holes GB380-165, hole centres 76-127-76mm

\*\* 料斗间距仅适用于三种流动性颗粒产品。

\* 安装孔 GB380-165, 孔中心 76-127-76mm。

<b>SPIDEX RANGE / SPIDEX 范围</b>												
Spidex 100-90-B	106	88	45	0.9	0.10	0.23	2	8.5	50	17	50	20.0
Spidex 100-90+B	106	88	45	0.9	0.12	0.23	2	8.5	50	17	50	20.0
Spidex 130-110-B	136	114	51	1.5	0.26	0.50	2	8.5	70	22	57	17.5
Spidex 130-110+B	136	114	51	1.5	0.31	0.50	2	8.5	70	22	57	17.5
Spidex 180-140-B	185	139	65	1.5	0.41	1.08	2	9.0	100	32	71	14.0
Spidex 180-140+B	185	139	65	1.5	0.50	1.08	2	9.0	100	32	71	14.0
Spidex 280-165-B	291	165	80	2.0	0.99	2.67	3	11.0	90	36	87	11.5
Spidex 280-165+B	291	165	80	2.0	1.32	2.67	3	11.0	90	36	87	11.5
Spidex 330-190-B	341	192	99	3.0	2.07	4.50	3	12.0	100	49	105	9.5
Spidex 330-190+B	341	192	99	3.0	2.82	4.50	3	12.0	100	49	105	9.5

Note: Spidex 100-90, Spidex 130-110 and Spidex 180-140 buckets have flat holes with notched back.

请注意: Spidex 100-90、Spidex 130-110 以及 Spidex 180-140 料斗具有背部有切口的扁平孔。