

# TYPE SPS

# Super Starco™



www.go4b.com



**FREE Engineering Design Service**  
Contact 4B

The new, extended range of the deep Super Starco™ buckets is the result of intensive research to achieve the maximum individual bucket capacity, while still maintaining the perfect fill and discharge characteristics of the original Starco bucket over a wide speed range.

El nuevo rango extendido del cangilón profundo Super Starco™, es el resultado de una búsqueda intensiva para conseguir la máxima capacidad individual por cangilón, mientras que mantiene las perfectas características de carga y descarga del cangilón Starco original sobre un amplio rango de velocidades.

- **Versatile bucket**, available in many sizes
- **Increased Volume**, with the same discharge characteristics as the Starco™ bucket
- **Less buckets required per metre**
- **Less bolts and punching required**
- **Reduced cost for belt & bucket installation**

- **Cangilón versátil**, disponible en muchas medidas.
- **Volumen aumentado**, con las mismas características de descarga que el modelo Starco
- **Se requieren menos cangilones por metro**
- **Se requieren menos tornillos y menos agujeros**
- **Se reduce el costo** por banda y por instalación de cangilón

**Pressed Seamless Steel /  
Stainless Steel**

**Chapa de acero estampada, sin  
soldaduras / Inoxidable**

AGRICULTURAL & INDUSTRIAL



**NEW  
BIGGER SIZES**

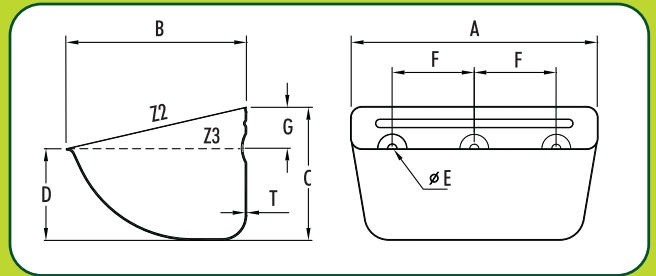

No.	A (mm)	B (mm)	C (mm)	D (mm)	T / Kg						Capacity (Litres) Capacidad (Litros)		Recessed Holes Agujeros Embudidos			Max. Pcs/Mtr	
					1.0mm	1.2mm	1.5mm	2.0mm	2.5mm	3.0mm	Z2 (total)	Z3 (water)	No.	E (Ø mm)	F (mm)		G (mm)
SPS80-80	85	80	58	39	0.11						0.21	0.18	2	8.0	43	16	15.00
SPS100-90	106	89	66	45	0.12		0.18			0.40	0.33	0.25	2	8.5	50	20	14.00
SPS100-100	105	97	78	46	0.18						0.42	0.29	2	8.5	50	25	12.00
SPS120-100	125	105	77	53	0.22		0.33				0.58	0.44	2	8.0	67	25	12.00
SPS140-110	146	112	91	40			0.43				0.76	0.41	2	8.5	70	25	10.50
SPS130-120	138	120	90	62		0.30	0.38				0.83	0.65	2	8.5	70	25	10.50
SPS140-120	146	120	90	62			0.40			0.80	0.87	0.65	2	8.5	70/86*	25	10.50
SPS160-140	166	147	112	78			0.55			1.10	1.58	1.20	2	8.5	100	30	8.60
SPS180-140	187	147	112	78			0.61			1.22	1.75	1.35	2	8.5	100	30	8.60
SPS200-150	205	150	112	77			0.77			1.54	2.00	1.53	2	9.0	100/102*	32	8.60
SPS230-160/A	233	160	122	85		0.86	1.15			1.72	2.72	2.05	3	9.0	70	32	8.00
SPS230-160/B	233	160	122	85		0.86	1.15			1.72	2.72	2.05	2	10.5	120	32	8.00
SPS240-160/A	247	165	130	92			1.35			2.00	3.03	2.37	3	10.5	70/77*	35	7.40
SPS240-160/B	247	165	130	92			1.35			2.00	3.03	2.37	2	10.5	140	35	7.40
SPS240-160/C	247	165	130	92			1.35			2.00	3.03	2.37	2	10.5	120	35	7.40
SPS260-165	262	165	130	92			1.38			2.10	3.28	2.55	3	10.5	77/80*	35	7.40
SPS280-165	289	167	132	93			1.55			2.32	3.78	2.95	3	10.5	80	38	7.40
SPS300-165/A	308	165	135	94			1.65			2.50	3.88	2.90	3	9.0	100/104*	36	7.20
SPS300-165/B	308	165	135	94			1.65			2.50	3.88	2.90	3	11.0	100	36	7.20
SPS330-165	340	165	135	97			1.90			2.85	4.40	3.50	3	11.0	110/120*	38	7.20
SPS350-165/A	360	165	135	94			2.12			3.20	4.50	3.65	4	9.0	90	38	7.20
SPS350-165/B	360	165	135	94			2.12			3.20	4.50	3.65	3	11.0	120	38	7.20
SPS230-170	235	170	132	93			1.40			3.09	2.40	2.40	2	11.0	120	35	7.00
SPS200-180	204	182	140	98			1.28			2.84	2.17	2.17	2	11.0	110	44	7.00
SPS260-180	270	188	140	96			2.00			4.10	3.20	3.20	3	11.0	80	45	7.00
SPS280-180	290	185	140	97			1.70		2.55	4.40	3.30	3.30	3	11.0	80	38	7.00
SPS300-180/A	308	182	140	95			1.80		2.70	4.50	3.50	3.50	3	9.0	100/104*	36	7.00
SPS300-180/B	308	182	140	95			1.80		2.70	4.50	3.50	3.50	3	11.0	100	36	7.00
SPS330-180	340	182	140	98			2.00			5.20	4.00	4.00	3	11.0	110/120*	38	7.00
SPS350-180/A	362	182	140	98			2.10		3.15	5.40	4.20	4.20	4	9.0	90	38	7.00
SPS350-180/B	362	182	140	98			2.10		3.15	5.40	4.20	4.20	3	11.0	120	38	7.00
SPS370-180	385	195	140	95				2.80		6.40	4.90	4.90	4	11.0	90	38	7.00
SPS250-215	257	215	162	113			1.86			5.30	4.10	4.10	3	11.0	85	49	5.88
SPS280-215	294	215	163	114			2.18	2.86	3.08	6.04	4.70	4.70	3	11.0	80	50	5.88
SPS300-215	310	220	163	112					3.48	6.70	5.20	5.20	3	11.0	100	50	5.88
SPS330-215	340	215	163	112				2.97		7.20	5.65	5.65	3	11.0	120	50	5.88
SPS350-215	362	215	163	112				3.23		7.60	5.86	5.86	3	11.0	120	50	5.88
SPS370-215	381	215	163	112				3.32	4.00	8.10	6.30	6.30	4	11.0	90	50	5.88
SPS440-215	450	225	165	113				3.92	4.68	9.83	7.44	7.44	4	11.0	110	50	5.88
SPS450-215	464	215	163	113				4.00	4.80	9.95	7.90	7.90	5	11.0	88/90*	50	5.88
SPS470-215	480	225	165	113				4.14	4.95	10.56	8.06	8.06	4	11.0	120	50	5.88
SPS500-215	515	215	163	113				4.28	5.14	11.25	8.80	8.80	5	11.0	100	50	5.88
SPS630-215	640	220	164	113						7.40	14.29	10.92	7	11.0	90	50	5.88

Special holes/thicknesses/wearbands - available on request  
Wear band size: 3.0mm on 1 or 3 sides on request.  
\* Slotted holes to fit alternate hole centres

Agujeros especiales/Espesores diferentes/Refuerzos especiales - Bajo Pedido.  
Medidas de los refuerzos: 3mm sobre 1 o 3 lados - A pedido.  
\* Agujeros ovalados para ajustarse a distintas distancias entre centros.

! For Stainless Steel, see price list for thickness options

! Para acero inoxidable, vea la lista de precios para opciones de espesor